

## Option 1: Alley Units



Pros:

---

---

---

Cons:

---

---

---

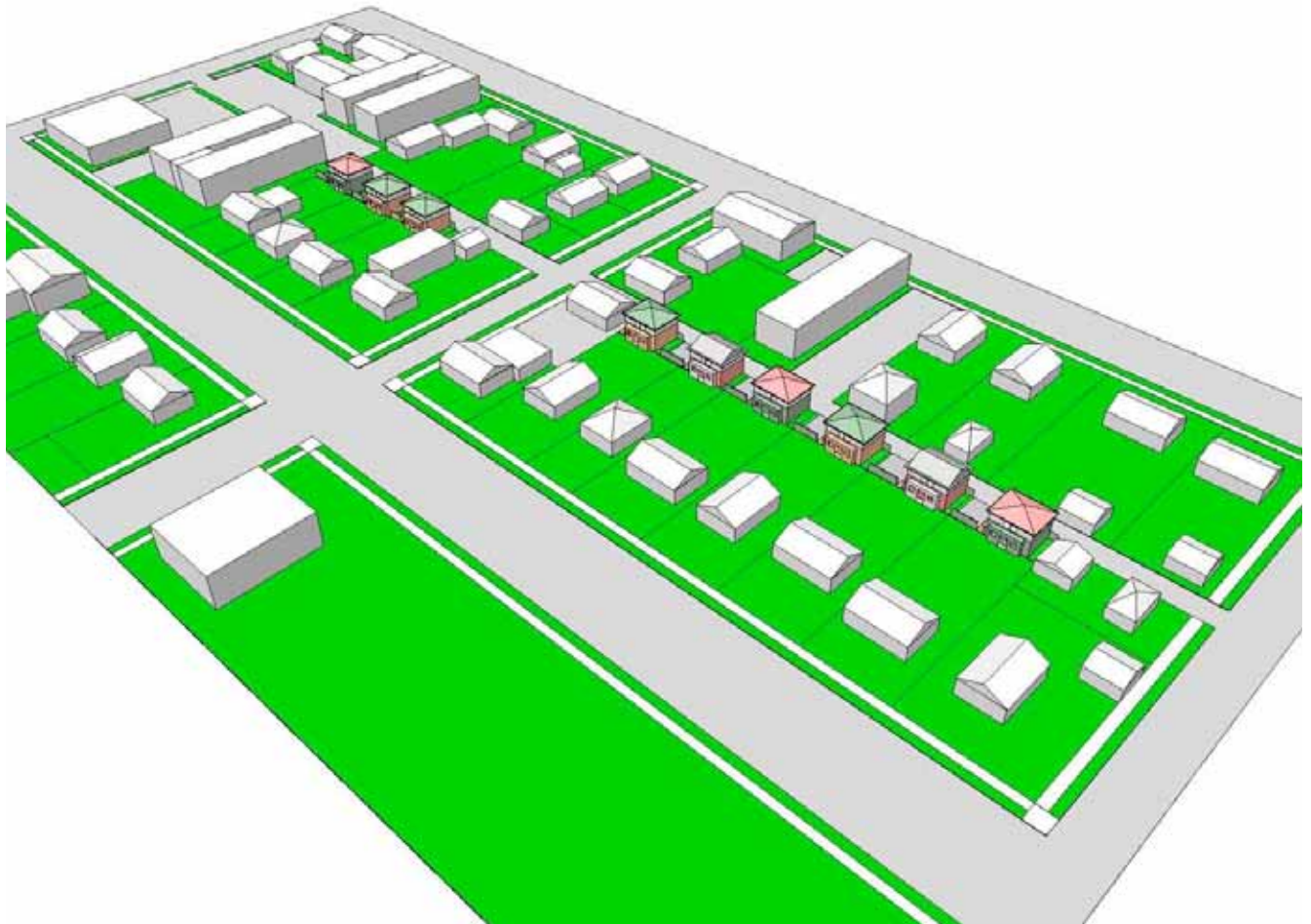
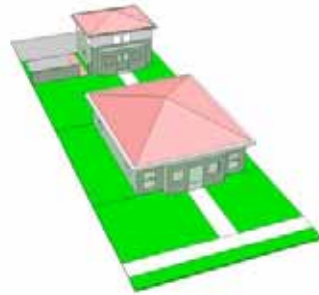

## Option 2: Duplexes and Alley Units

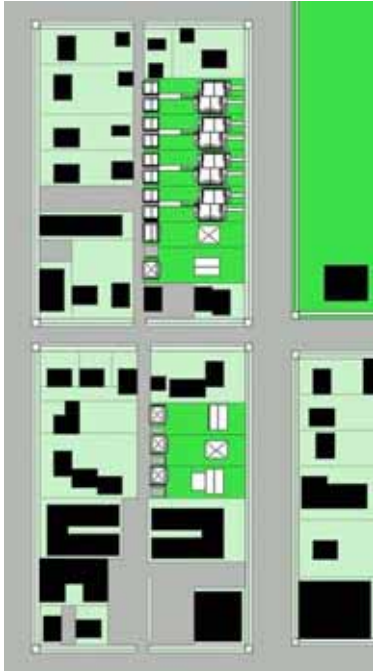

Pros:

---

---

Cons:

---

---

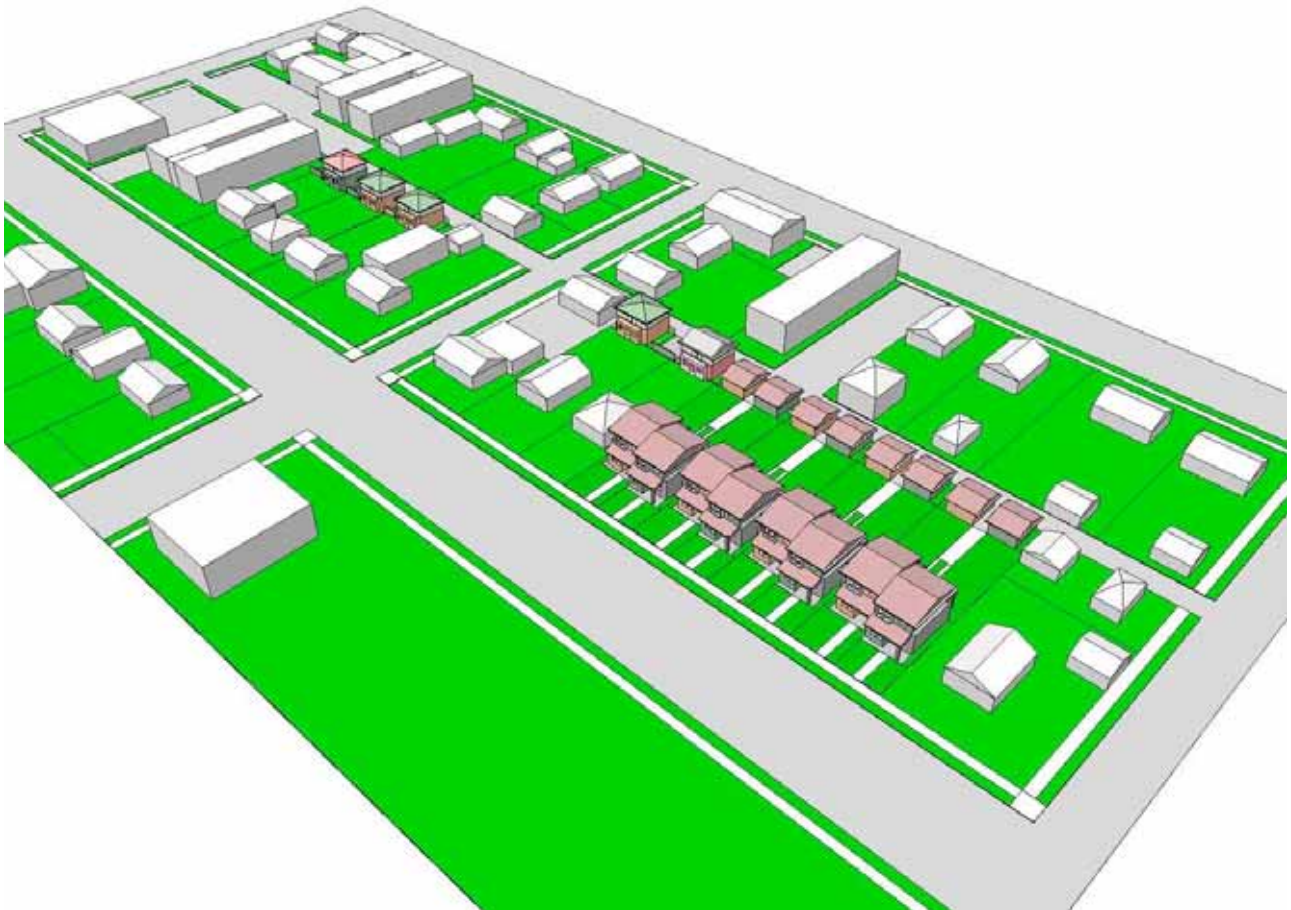
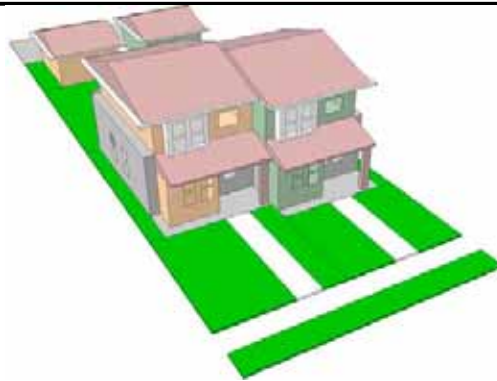

### Option 3: Row Houses and Duplexes

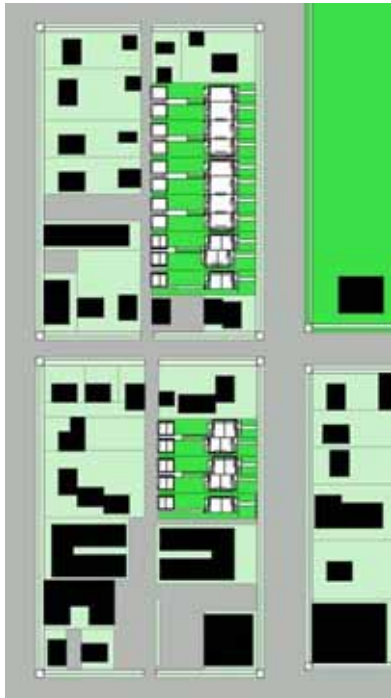

Pros:

---

---

Cons:

---

---



## Option 4: Flats and Row Houses

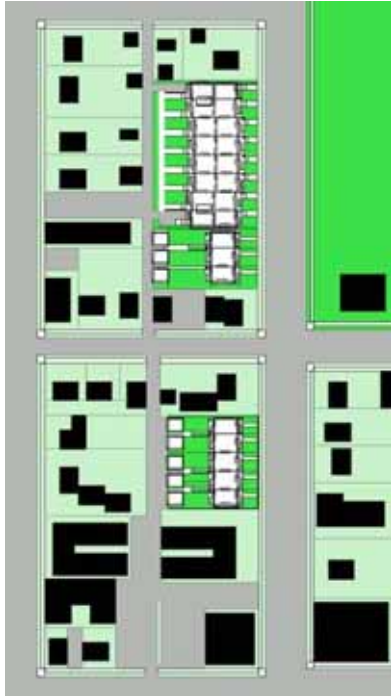

Pros:

---

---

Cons:

---

---

