



PARKING & ON-STREET WASTE RECEPTACLE LOCATIONS COMPLETE SITE

NOTES:

1. TWO RECEPTACLES (REFUSE & RECYCLE) ARE ASSIGNED TO EACH UNIT AND ARE COLLECTED EVERY WEEK.
2. BUILDING FOOTPRINTS ARE SHOWN FOR ILLUSTRATIVE PURPOSES. DEVELOPER RESERVES THE RIGHT TO MODIFY BUILDING FOOTPRINTS SUBJECT TO "SUBSTANTIAL CONFORMANCE" DETERMINATION BY THE COMMUNITY DEVELOPMENT DEPARTMENT.

LEGEND

- REFUSE / RECYCLE RECEPTACLE LOCATION
- PROPOSED ON-STREET PARKING LOCATION
- PROPOSED FIRE HYDRANT LOCATION

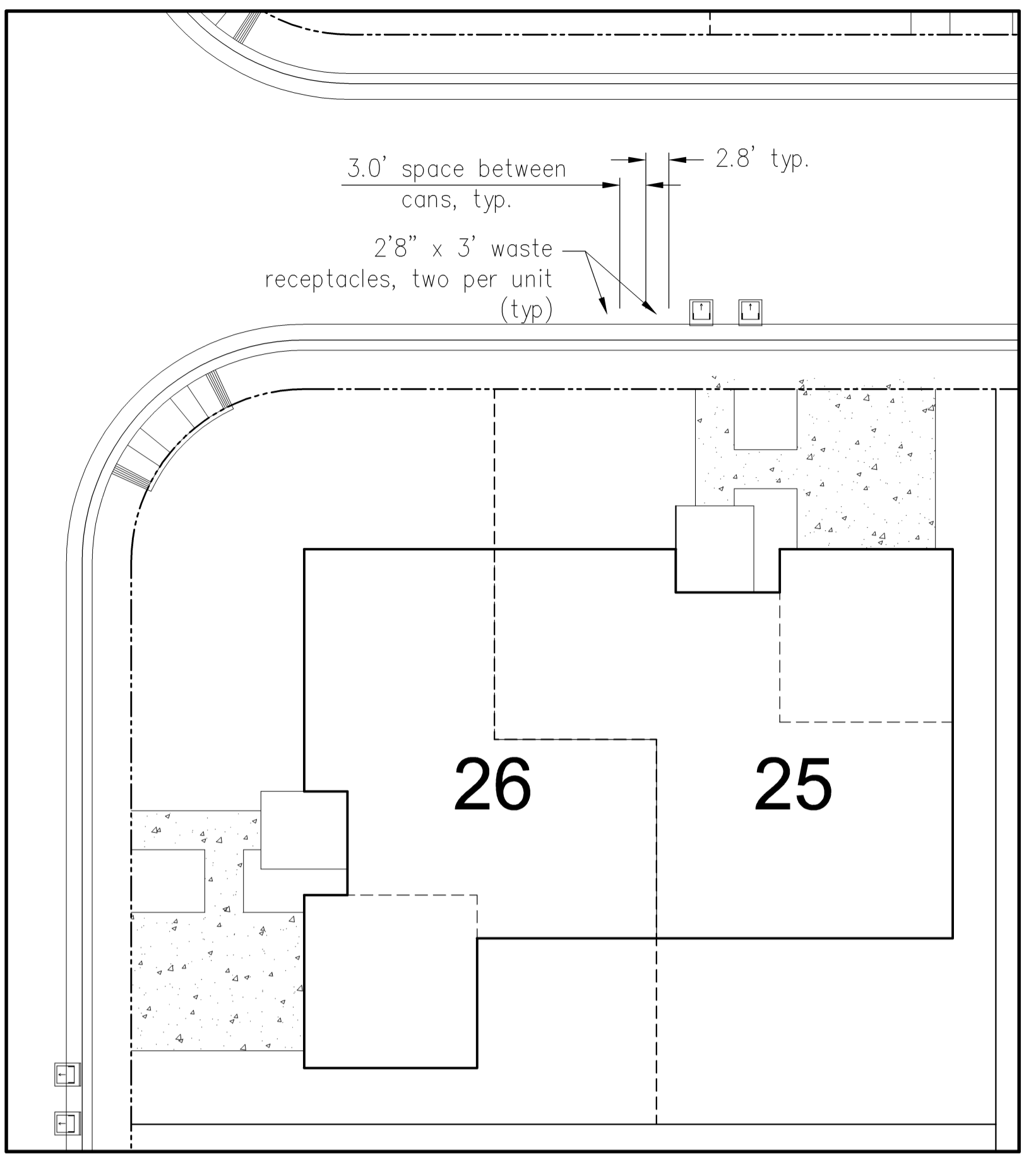
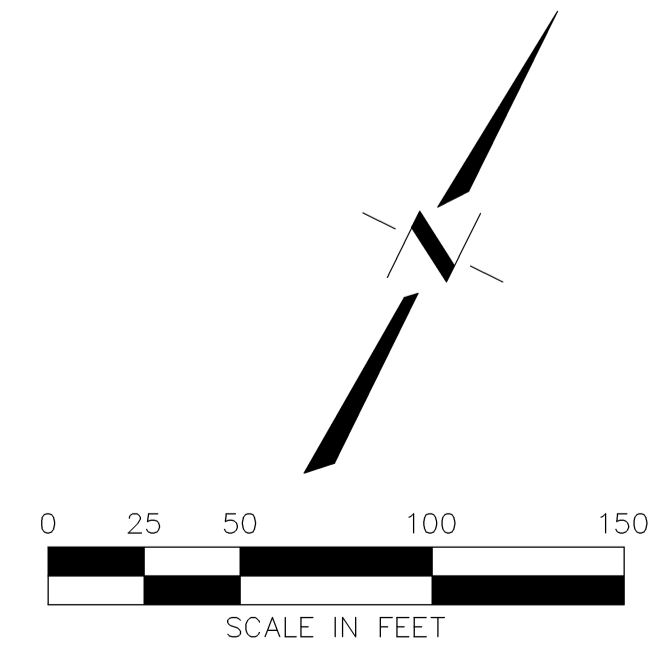

A TYPICAL RECEPTACLE PLACEMENT
N.T.S.

PARKING SUMMARY

PARKING TYPE	REQ'D	PROVIDED
RESIDENT OFF-STREET PARKING (2 spaces per unit required)	41 x 2 = 82	164
ADDITIONAL ON-STREET GUEST PARKING		47
TOTAL:		211

DESIGNED BY: MR. SM
DRAWN BY: MR. SM
CHECKED BY: MR. SM
SCALE: 1" = 50'

APPD. BY: _____
BY: _____
REVISIONS: _____
DATE: _____
NO. _____

CECWEST.COM
Project Planning • Civil Engineering • Landscape Architecture
Sacramento Office
220 20th Street, Suite Three
Sacramento, CA 95818
(916) 455-2026

CUNNINGHAM ENGINEERS

VESTING TENTATIVE SUBDIVISION MAP
DAVIS JOINT UNIFIED SCHOOL DISTRICT
GRANDE - SUBDIVISION MAP NO. 4945
PARKING & ON-STREET WASTE RECEPTACLE LOCATION EXHIBIT
CITY OF DAVIS
CALIFORNIA

SHEET 1 OF 1
DATE: 9/12/08
JOB NO: 931.04