

Survey March 2002
 by John McNewey
 City of Davis Wildlife Specialist

DEERING DESIGN
 SITE PLANNING
 URBAN DESIGN
 LANDSCAPE ARCHITECTURE
 3 Parkside Dr.
 Davis, CA 95618
 phone (530) 756-8334
 fax (530) 756-8434
 www.deeringdesign.com
 Calif. LA #11976
 Nevada LA #1150



DATES

△	2/14/02	△	
△		△	
△		△	
△		△	

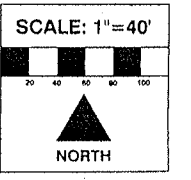

WILDHORSE UNIT 1
DAVIS GREENBELT
 POLE LINE RD. TO COVERL CHANNEL
 FOR WILDHORSE GROUP LLC.

SHEET NO.
 1 OF 3

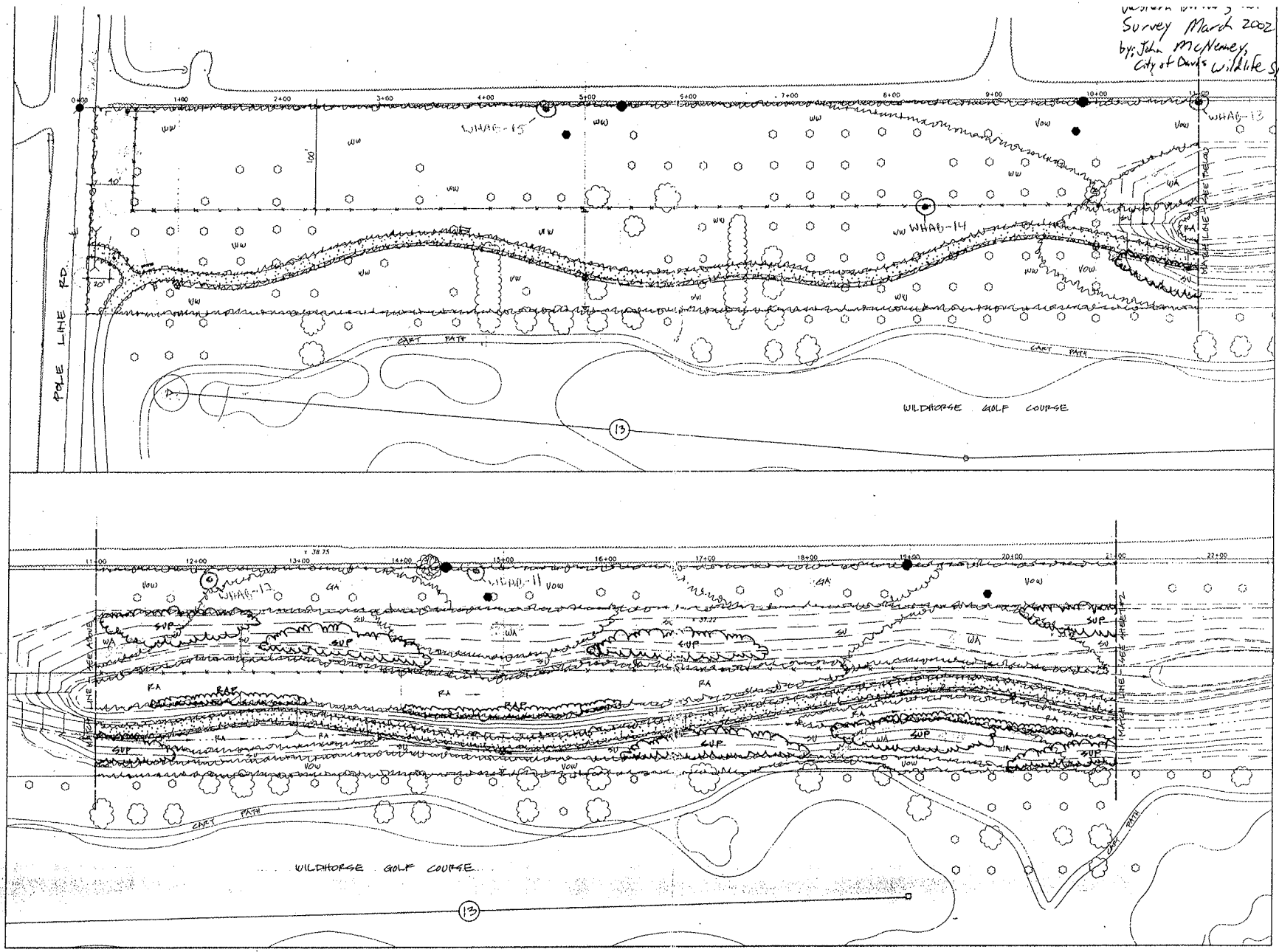

DEERING DESIGN

SITE PLANNING
URBAN DESIGN
LANDSCAPE ARCHITECTURE

3 Parkside Dr.
Davis, CA 95618
phone (530) 758-0266
fax (530) 758-6541
email deering@pole.com

CA Lic. LA #1976
Nevada LA #190



DATES

△	2/14/11	△	□
△	□	△	□
△	□	△	□
△	□	△	□

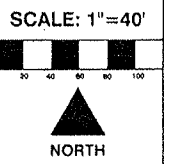

WILDHORSE UNIT 1
DAVIS GREENBELT
POLE LINE RD. TO GOVELL CHANNEL
FOR
WILDHORSE GROUP LLC.

SHEET NO.
2 OF **3**

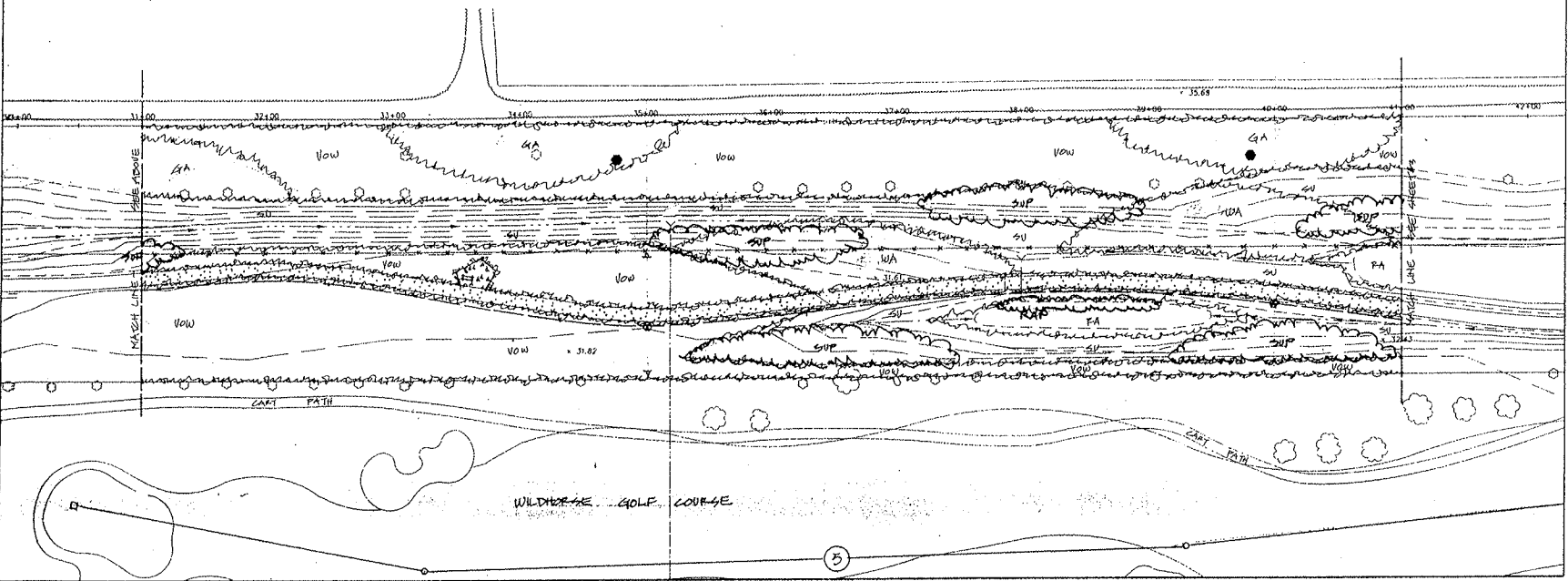
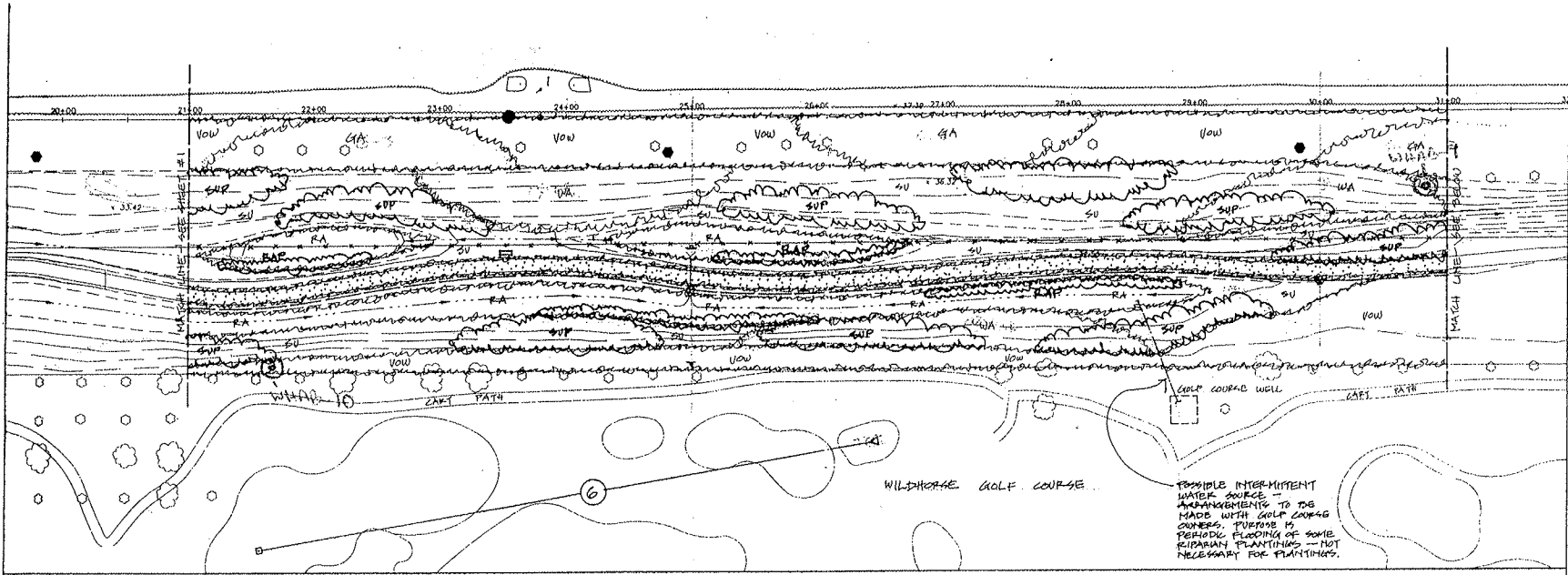

24

DEERING DESIGN

SITE PLANNING
URBAN DESIGN
LANDSCAPE ARCHITECTURE

2 Parkside Dr.
Davis, CA 95618
phone (916) 756-0258
fax (916) 756-0254
email deering@yodo.com

CALIF. LA #1979
Nevada LA #150

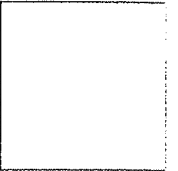
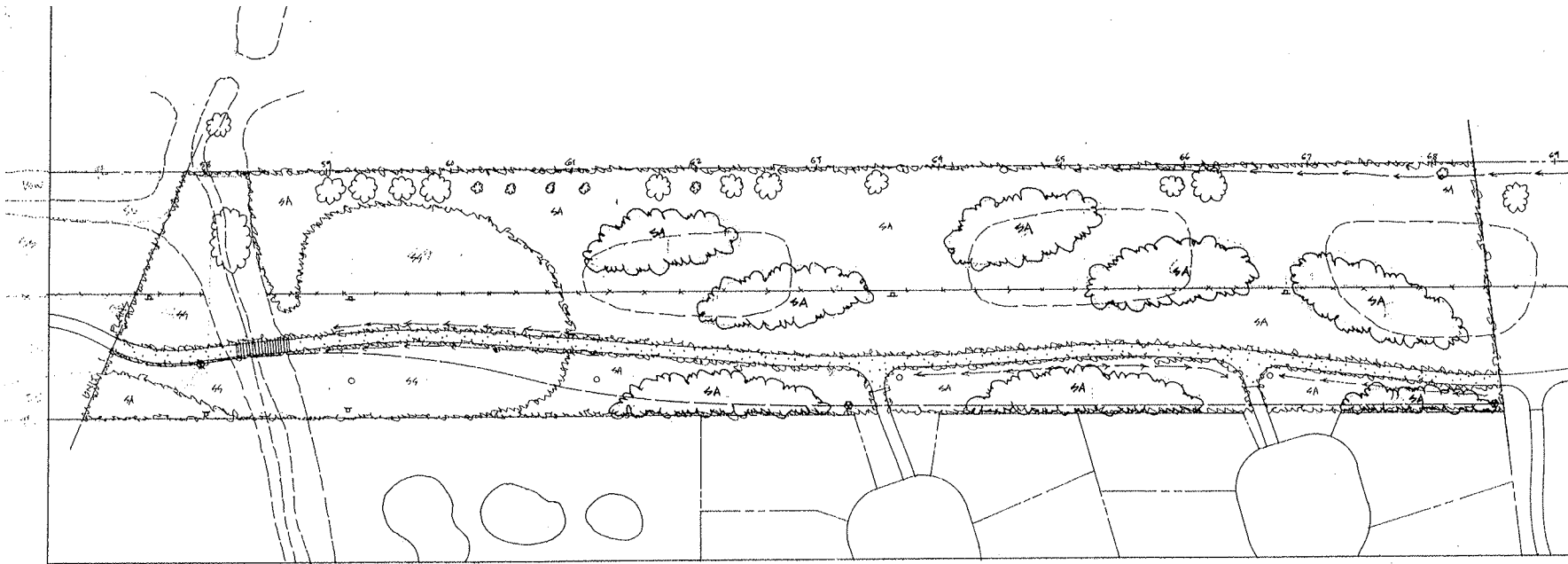

DATES

△	11/14/11	△	□
△	□	△	□
△	□	△	□
△	□	△	□

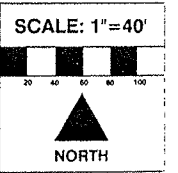

WILDHORSE UNIT 2
DAVIS GREENBELT

COVELL CHANNEL TO COVELL BLVD.

FOR
WILDHORSE GROUP LLC.

SHEET NO.
1 OF 2

DEERING DESIGN

SITE PLANNING
URBAN DESIGN
LANDSCAPE ARCHITECTURE

3 Parkside Dr.
Davis, CA 95618
phone (530) 756-0226
fax (530) 756-8426
email deering@yahoo.com
Calif. LA #1979
Hawaii LA #150

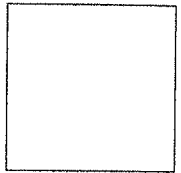

DATES

△	5/15/11	△	□
△	□	△	□
△	□	△	□
△	□	△	□

SCALE: 1"=40'



**WILDHORSE UNIT 2
DAVIS GREENBELT**

COVELL CHANNEl TO COVELL BELT

FOR
WILDHORSE GROUP LLC.

SHEET NO.

2 OF 2

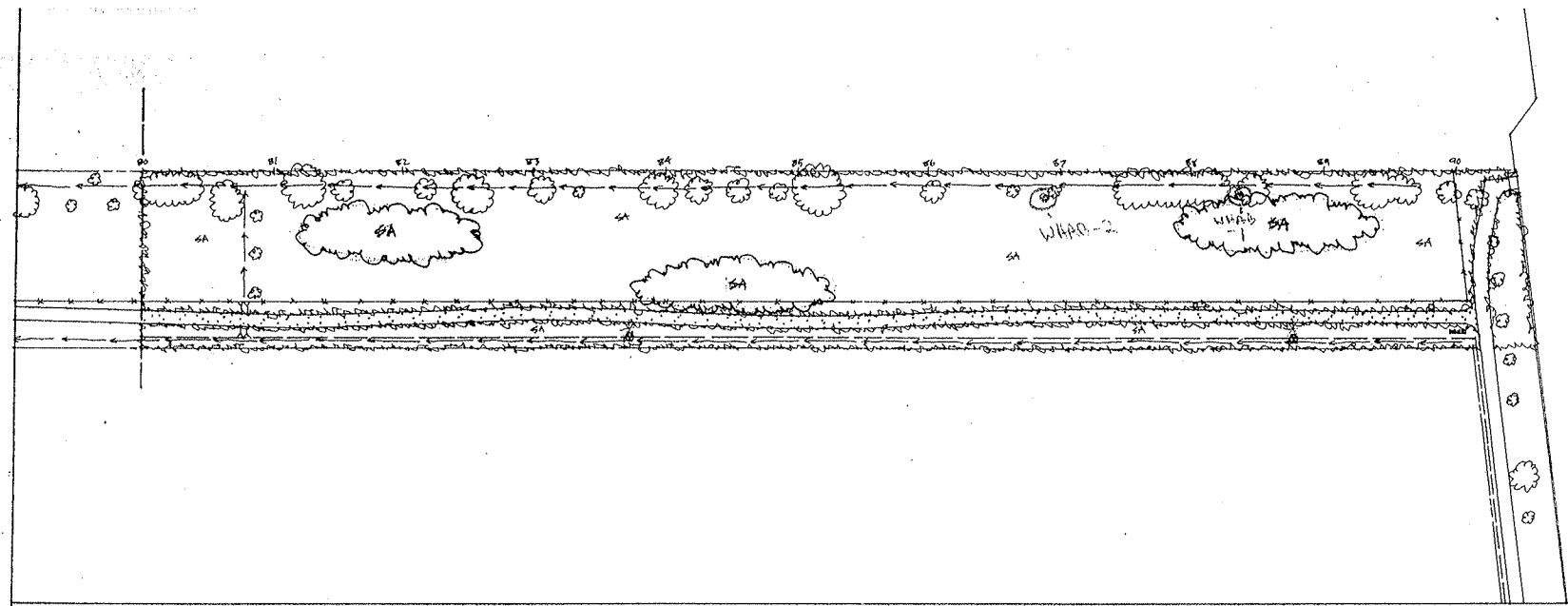

KEY

---: Install Park-rite bike rack model #2202-069 (Park's B bikes) where shown on the plans at Covell Blvd. entrance (Shore Park Pkwy at 010) 330-4367. Anchor with two 1/2" x 1/2" concrete bolts.

---: Street Sign: Construct as per Univ. 1 detail.

---: Drainage: Install catch basins per City Standard (if required), on PVC main line per City Standards where shown on the plans.

---: Signs: Provide and install signs at Pole Line Rd. entrance and at regular intervals where shown on plans; signs which make clear restrictions on access to golf course and agricultural buffer areas. Sign size, construction and content shall be reviewed and approved by City Parks Dept. Start prior to installation (start to metal sign) (approximate 1 mo. in on-line (EOW) time).

---: Wire Mesh Fence: Construct as per Univ. 1 detail.

PLANT MATERIALS

---: EROSION CONTROL SEEDING (see specifications for seed mixes)

---: Shrubland Area seed mix

---: Sycamore Savanna seed mix

---: NATIVE SPECIES PLANTING (see specifications for plants and quantities)

---: Shrubland Area Plants - Install linear plantings where shown on the plans using spacings called for on page 22 of the specifications.

---: Sycamore Savanna Plants - Plant within the Sycamore Savanna seeding area, the quantities called for on page 22 of the specifications. Using spacings called for, plant in three or more "islands" in low spots or other locations where survival is most likely.

27