

**EXISTING CHILES ROAD SECTION**  
NTS

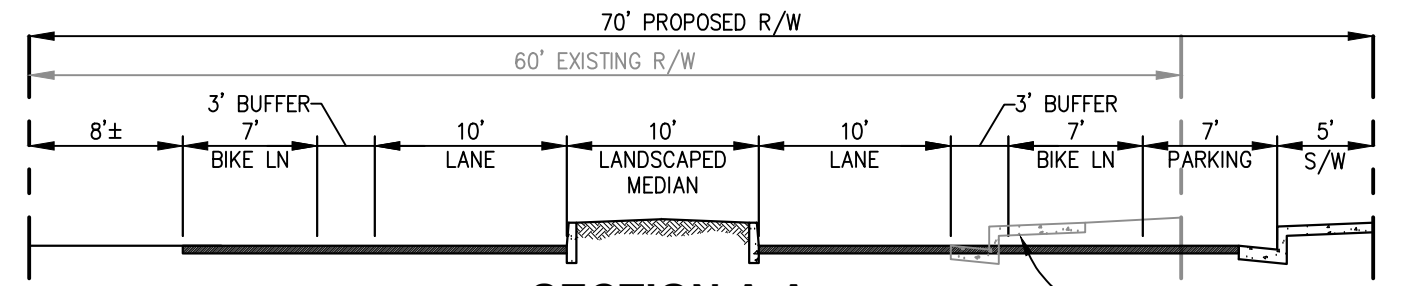

**SECTION A-A**  
NTS

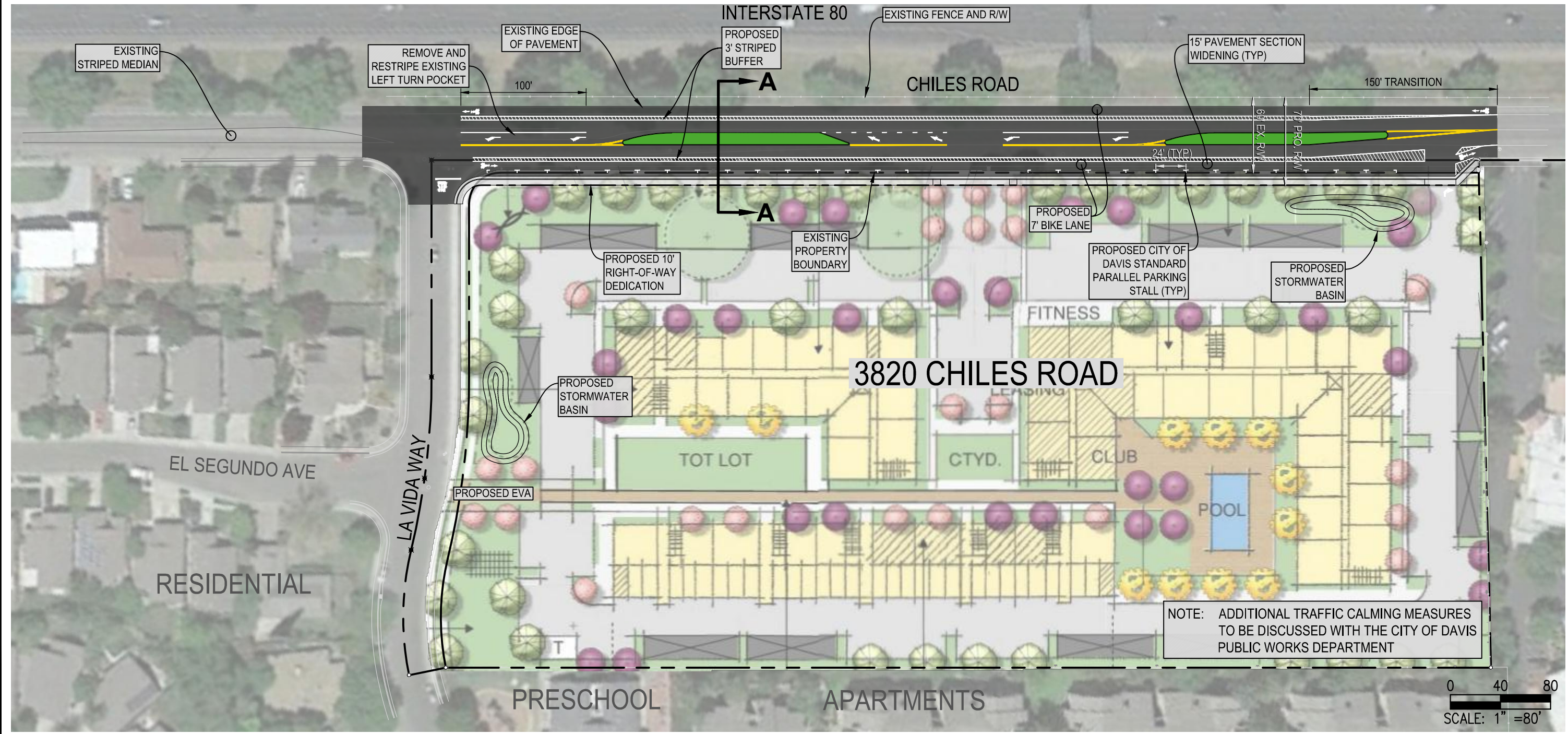

NOTE: ADDITIONAL TRAFFIC CALMING MEASURES TO BE DISCUSSED WITH THE CITY OF DAVIS PUBLIC WORKS DEPARTMENT

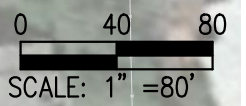

DESIGNED BY: \_\_\_\_\_  
DRAWN BY: NC  
CHECKED BY: CWC  
SCALE  
1" = 80'

**CUNNINGHAM ENGINEERING**  
CECWEST.COM  
Project Planning ■ Civil Engineering ■ Landscape Architecture  
Sacramento Office: 2120 20th Street, Suite Three, Sacramento, CA 95818 (916) 455-2026  
Davis Office: 2940 Spafford Street, Suite 200, Davis, CA 95618 (530) 758-2026

DAVIS

**3820 CHILES ROAD**  
**PROPOSED CHILES ROAD WIDENING EXHIBIT**

CALIFORNIA

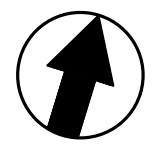

SHEET  
**1**  
OF  
**1**  
DATE: 02/05/2019  
JOB NO: 1579.01