



Introduction

The City of Davis is conducting the Davis Amtrak Station Access & Connections Study, which will identify long- range opportunities to increase ridership on Amtrak, improve multimodal accessibility, and enhance station safety in Davis. In addition, the study will examine the potential benefits of implementing such changes including relieving congestion on local roadways, reducing vehicle miles traveled, and stimulating economic activity in downtown Davis. The study is funded by a Caltrans planning grant.



Aerial view of the project area

Purpose

The project team facilitated three pop-up workshops to engage the community where they already congregate. The pop-up workshops provided an opportunity to engage the public about their visions for the future of the station.

Below are the dates, times and locations of each pop-up workshop that took place:

<p>Friday, September 13, 2019 5:00 – 7:00 pm 2nd Friday ArtAbout Corner of 2nd and E Street</p>	<p>Saturday, September 14, 2019 9:00 – 11:00 am City Hall at the Farmers Market Central Park</p>	<p>Wednesday, September 18, 2019 4:30 – 6:30pm Davis Farmers Market Central Park</p>
---	---	---

Format

Community members were encouraged to stop by and provide input on two interactive board displays with post-it notes and dot stickers. The project team received input from than fifty (50) people at all three pop-up workshops.

The interactive board displays and the informational board display at the pop-up workshops are outlined on the next page.

See the Appendix for full renderings of the board displays.



Community members review the board displays



Board 1: Site Overview

This board display presented an aerial view of the station area including the station building, adjacent train platforms, and the parking lot with one public entrance. The map of the station area was overlaid with the number of station users that access the station by foot, on bikes, or by car over the course of twenty (20) hours in one day. The bottom of the board also displayed a graphic depicting the interior layout of the depot building. Community members were asked to write ideas for improving station access on post-it notes.

Board 2: Driveway Counts

This board display presented a table detailing the driveway counts of people entering and exiting the station area over the course of twenty (20) hours. The data are represented with circles of varying sizes and colors depending on the number of people crossing into the station area and what mode of transportation they used.

Board 3: Results of the User Survey

This board display presented an overview of the results of the user survey conducted in June of 2019. The survey asked community members to self-identify as a regular or irregular station user and list their priorities for station improvements. The priorities were ranked from most to least important and compared between regular and irregular station users. Community members were encouraged to contribute their feedback to the survey results with dot stickers.



Board 1: Site Overview

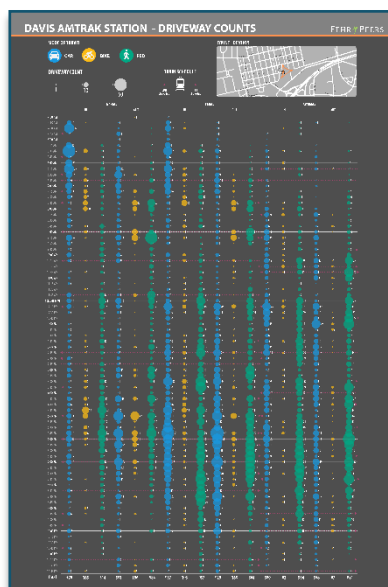

Board 2: Driveway Counts

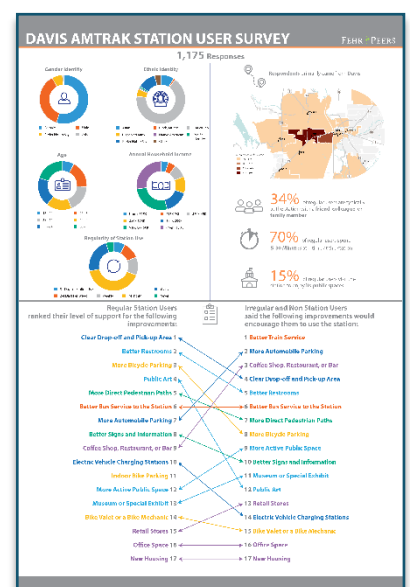

Board 3: Results of the User Survey



Community Feedback

The Davis Amtrak Station Access & Connection Study project team received more than fifty (50) responses from community members throughout the pop-up workshop series. A comprehensive list of raw community member comments is available in the appendix.

Many of the key themes that emerged during conversations with community members revolved around improvements to bicycle parking at the station area. Workshop attendees expressed the desire for more bicycle parking, both inside a secure building, and outside near the rail platforms. Additionally, some workshop attendees mentioned wanting to see a JUMP bicycle charging station. Similarly, many people discussed the need for more vehicle parking capacity, both at the station area, and in the surrounding neighborhoods. Some of the other more frequent improvements suggested by community members were adding more access points for different modes of transportation at various locations around the station and rail tracks. Community members also expressed their concerns about safety, particularly the safety of pedestrians entering the station area and security of parked vehicles and bicycles.

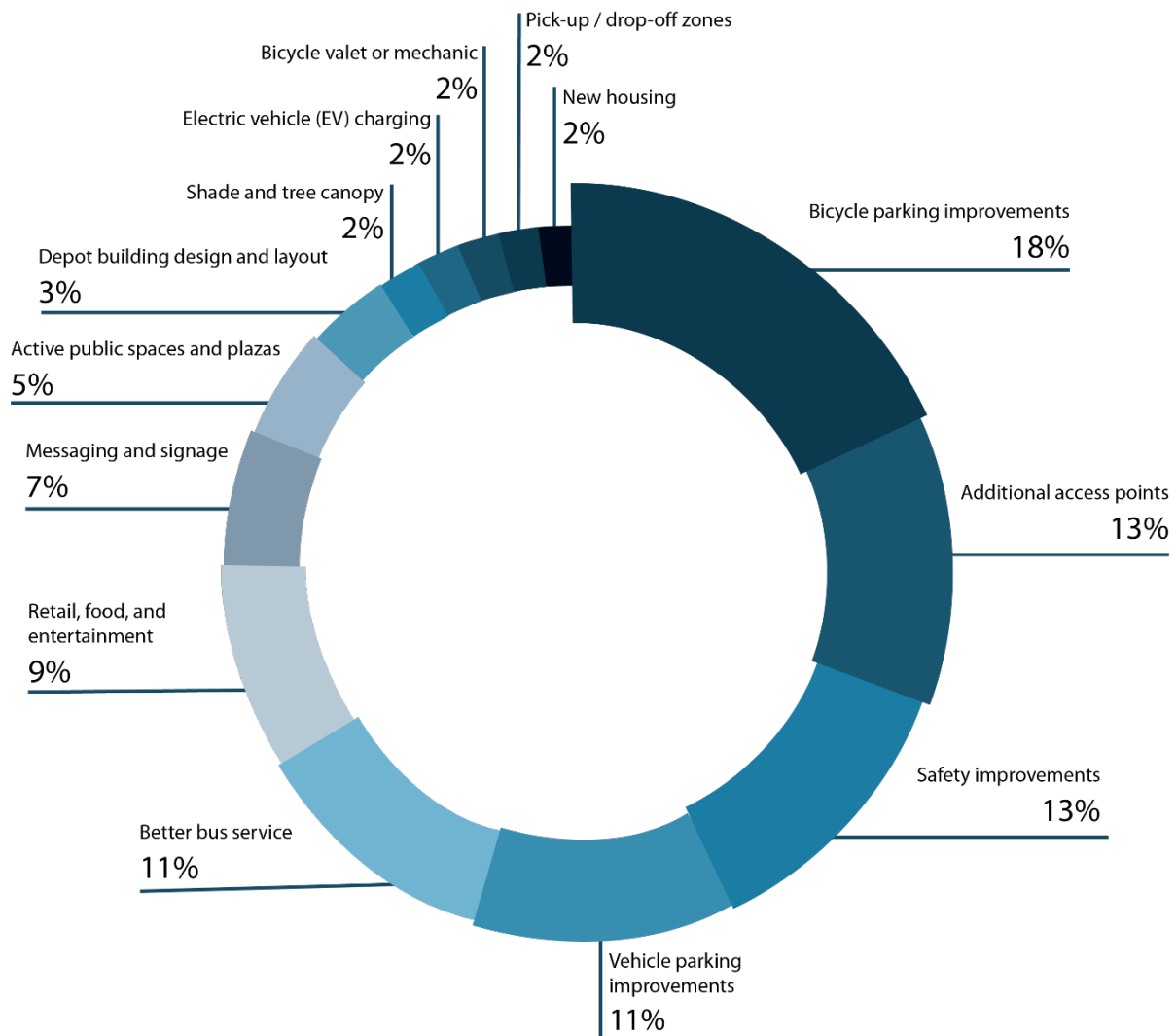



Comments from Board 1

Community members gave several ideas for parking improvements including converting the existing parking lot at the station into a four-story parking structure, constructing a parking garage at the vacant lot behind Design House on Olive Drive, having reserved parking spots for car rentals, and allowing public parking in the existing lot for more hours out of the day. One community member suggested removing all parking spots along H Street adjacent to the station to allow more space on the street for buses, pedestrians, and cyclists.

Currently, only one public entrance to the station for motorists, cyclists, and pedestrians exists at the intersection of H and 2nd Street. Many community members voiced their concern for the safety of pedestrians and cyclists entering the station area at this entrance, as there is no clear right of way. Some workshop attendees also suggested adding a bike and pedestrian path that connects from the south side of the station to Richards Boulevard and a path that connects from the station to East Davis neighborhoods. One person noted that there should be JUMP electric bicycle charging stations in or adjacent to the station area that would allow more people to use this mode of transportation to reach the station.

Another important improvement that community members brought up, is wanting to see more lines and bus service to the station area and adding more stops in the surrounding neighborhoods. Furthermore, community members also want better signage and messaging for bus stops and train times inside the depot building and along the rail platforms.

Workshop attendees made several suggested safety improvements. Some people like the current layout of the rail platforms, and some contended that the design limits visibility of some areas of the rail platforms. There was also concern over the safety and security of the bike parking spots. One community member suggested adding security cameras to make bicycle and vehicle parking safer. Many people who contributed to the boards want to see an open public plaza in or around the station area with many retail and food options for visitors. Some workshop attendees also want to see the depot building expanded, remodeled, or better maintained, particularly the interior.

Finally, one workshop attendee noted that since Davis experiences very hot weather during the summer, there should be a larger tree canopy in and around the station area and rail platforms to shade passengers who are waiting.



Community member adds a comment to the interactive board display



Project team discusses the Amtrak station with a community member



Results from Board 3

Below are two graphs depicting results of the online user survey from June of 2019. The improvements were ranked as a result of the survey (1 being the most important and 17 being the least important) and divided between regular and irregular station users. The percentages in the graphs below show the additional support that pop-up workshop attendees showed for station improvements.

Regular station users ranked their level of support for the following:

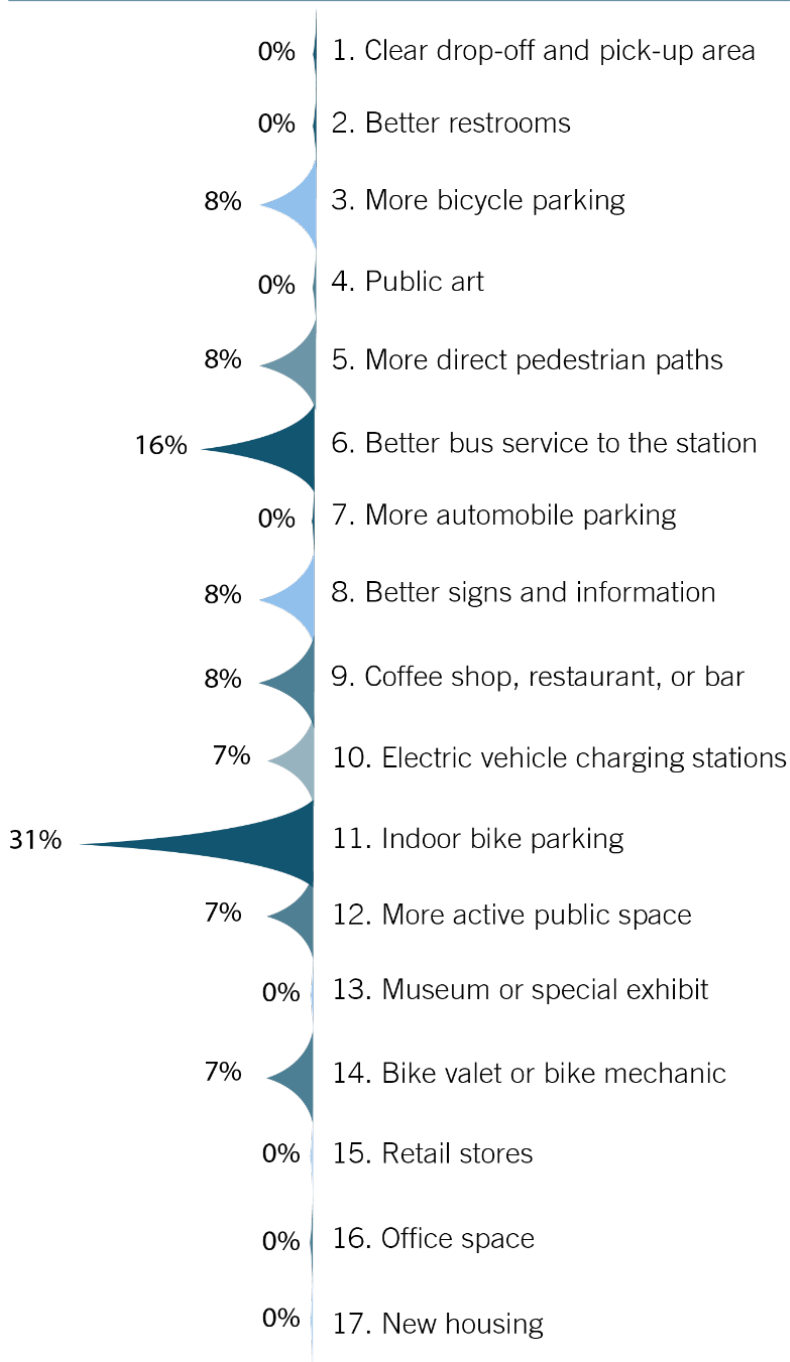



Irregular and non station users said the following would encourage them to use the station

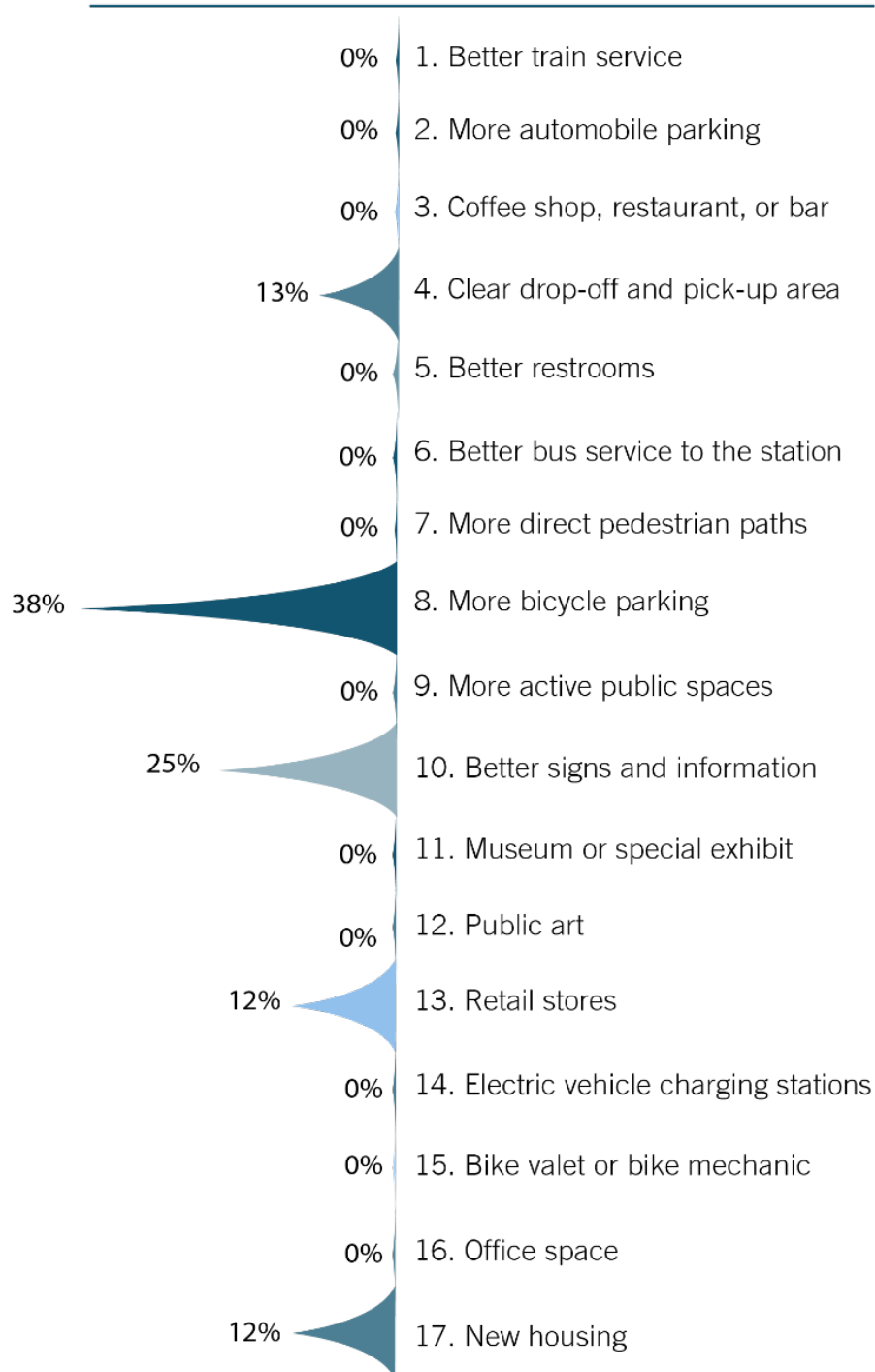



Notification

An email and follow-up reminders were sent to more than 1,200 community members.

Information about the pop-up series was posted on the City of Davis website and social media. An event page was created on Facebook for each of the three pop-up workshops.

The flyer is titled "IMPROVE YOUR STATION EXPERIENCE" and features a photo of two people at a station. It lists three pop-up workshops: Friday September 13 (5:00-7:00 p.m.), Saturday September 14 (9:00-11:00 a.m.), and Wednesday September 18 (4:30-6:30 p.m.). It also includes a section "ABOUT THE DAVIS AMTRAK ACCESS AND CONNECTIONS STUDY" and contact information for the City of Davis.

IMPROVE
YOUR STATION EXPERIENCE

Join the City of Davis for a series of **Pop-up Workshops!**

- **Friday September 13**
Corner of 2nd and E Street
5:00 - 7:00 p.m.
Learn about the Davis Amtrak Access and Connections Study.
- **Saturday September 14**
Central Park, City Hall
at the Farmer's Market
9:00 - 11:00 a.m.
Learn about how people travel to and use the Davis Depot.
Find out what community members have said they want to see at the station in the future.
- **Wednesday September 18**
Central Park, Farmer's Market
4:30 - 6:30 p.m.
Provide your vision for future uses of the Amtrak Station.

ABOUT THE DAVIS AMTRAK ACCESS AND CONNECTIONS STUDY

The City of Davis is studying for the future of the Amtrak Station, commonly known as the "Davis Depot."

The study seeks to identify long term opportunities to increase ridership, improve access for different types of travel, and enhance station safety. In addition, the study will examine the potential benefits of implementing such changes including relieving congestion, reducing car travel, and stimulating economic activity downtown.

Visit the project website at www.CityofDavis.org/DepotStudy

Questions? Email gashimoto@cityofdavis.org or call 530-747-5809

Davis
California

Notification flyer for the pop-up series



Appendix

- Community Member Comments
 - Bus announcement versus noise ordinance in the early mornings. Changeable message signs for buses.
 - More visibility for Amtrak agent.
 - Link via bike path along the tracks and construct bike bridge over Richards Boulevard to UC Davis.
 - Security cameras for bike parking.
 - Dual use parking for commuters and downtown visitors.
 - Sight lines are great. Keep them open.
 - More shade around station and drop off area. Asphalt reaches 150 degrees in the sun.
 - Consider Amtrak depot a bus mobility hub and transit center.
 - Improve depot interior and maintenance.
 - Make the current parking lot a four-story parking structure
 - Remove the car parking on H Street adjacent to station
 - Add bus stops to the west side of 3rd Street at intersection with H Street.
 - Who has right of way at 2nd Street and H Street?
 - Need a stop sign on 2nd Street eastbound at H Street. Dangerous to pedestrians.
 - Station-focused retail and entertainment on H Street where backside of Village Bakery, buildings and parking currently exists.
 - Close H Street south of station driveway and convert to active entertainment plaza.
 - When Union Pacific Railroad tracks are eliminated, convert most of parking lot into active park or plaza.
 - More parking.
 - More direct access points on east and south side of the station (2 votes).
 - JUMP bike charging rack.
 - Parking garage behind Design House and path to station.
 - Express bus from west Davis to the station at 2 or 3 times in the morning. Pick up West Lake Market (2 votes).
 - Provide space for car rentals.
 - Public meeting space inside the depot.
- Notification Flyer
- Board Displays
- Comment Card

IMPROVE

YOUR STATION EXPERIENCE



Join the City of Davis for a series of **Pop-up Workshops!**

- **Friday September 13**
Corner of 2nd and E Street
5:00 - 7:00 p.m.
- **Saturday September 14**
Central Park, City Hall
at the Farmer's Market
9:00 - 11:00 a.m.
- **Wednesday September 18**
Central Park, Farmer's Market
4:30 - 6:30 p.m.

Learn about the Davis Amtrak Access and Connections Study.

Learn about how people travel to and use the Davis Depot.

Find out what community members have said they want to see at the station in the future.

Provide your vision for future uses of the Amtrak Station.

ABOUT THE **DAVIS AMTRAK ACCESS AND CONNECTIONS STUDY**

The City of Davis is studying for the future of the Amtrak Station, commonly known as the "Davis Depot."

The study seeks to identify long term opportunities to increase ridership, improve access for different types of travel, and enhance station safety. In addition, the study will examine the potential benefits of implementing such changes including relieving congestion, reducing car travel, and stimulating economic activity downtown.

Visit the project website at www.CityofDavis.org/DepotStudy

Questions? Email gashimoto@cityofdavis.org or call 530-747-5809



DAVIS AMTRAK STATION - DRIVEWAY COUNTS

MODE OF TRAVEL



DRIVEWAY COUNT

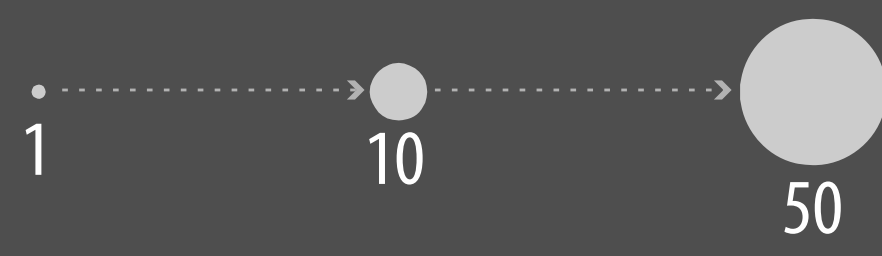

TRAIN SCHEDULE



COUNT LOCATION

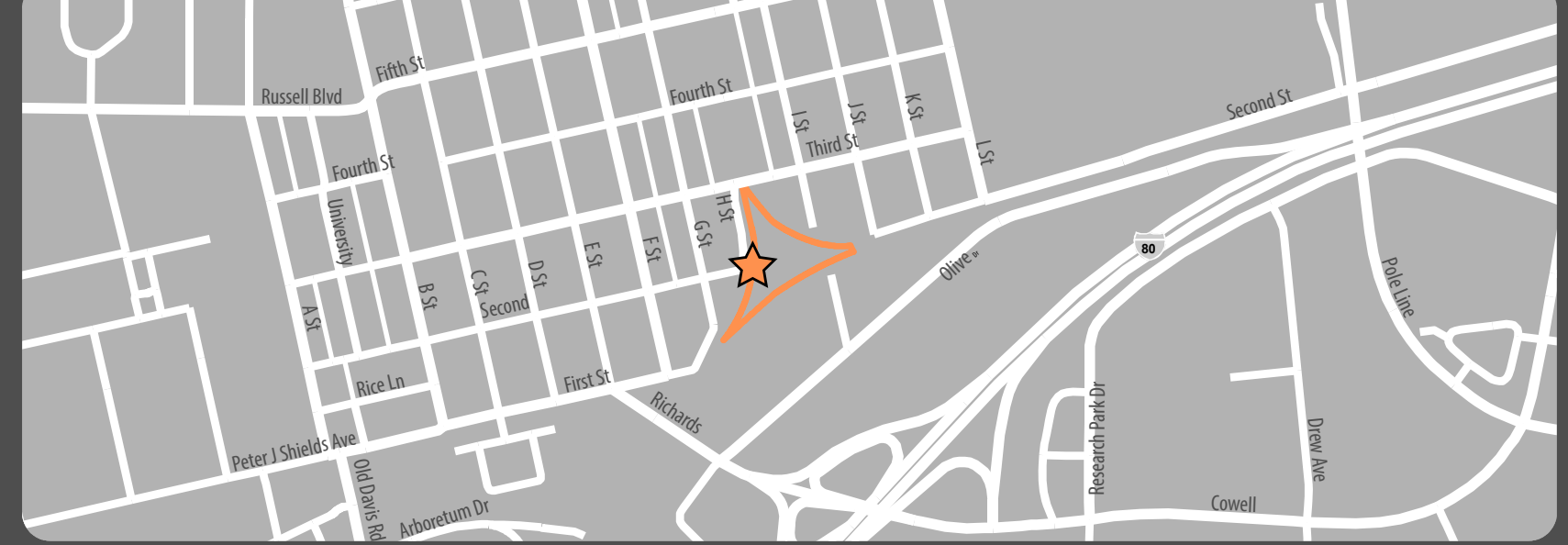

DAVIS AMTRAK STATION

SHARE YOUR THOUGHTS
What improvements would you like to see?



WRITE ADDITIONAL IDEAS HERE

BUILDING DETAILS

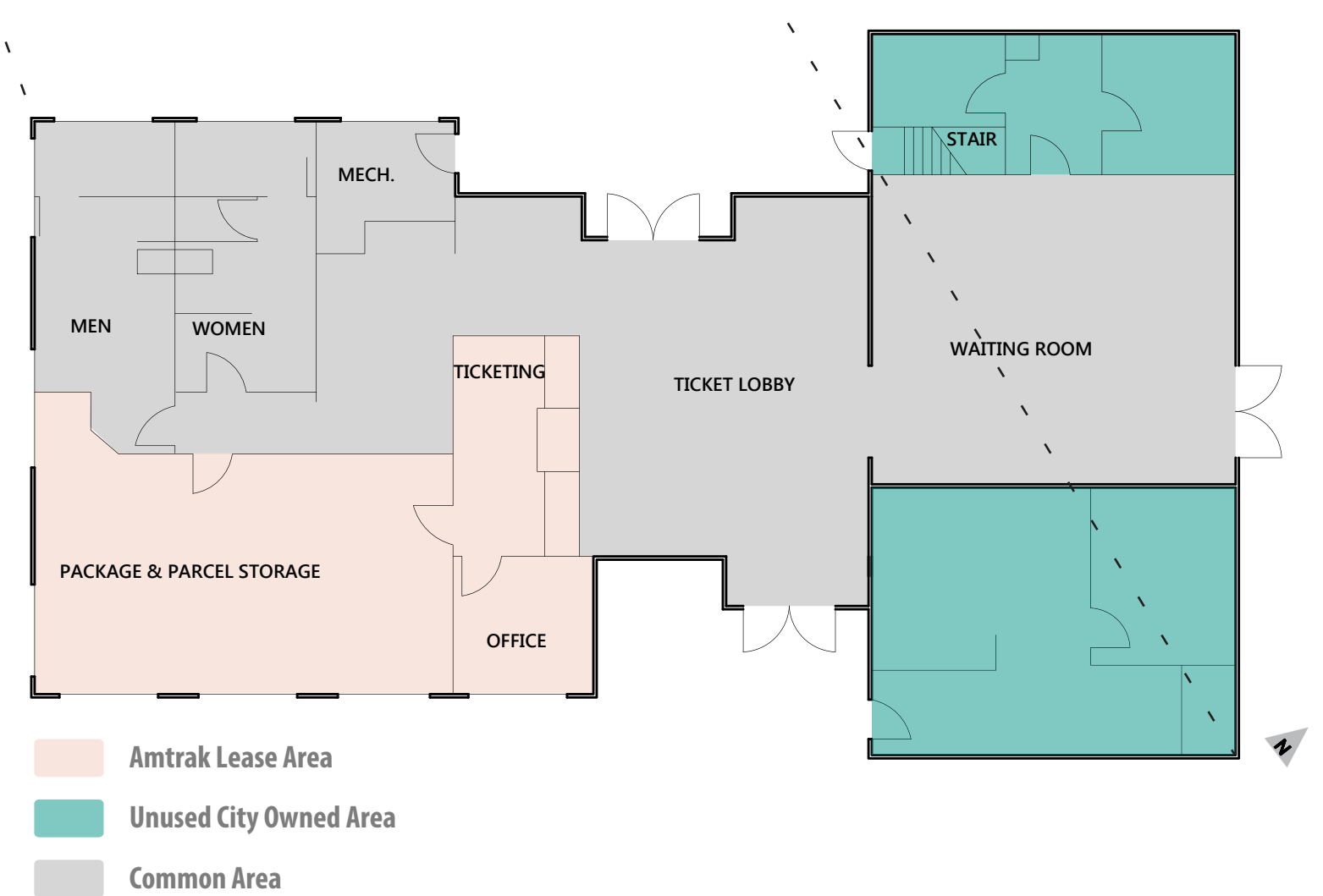

1,175 Responses

Gender Identity

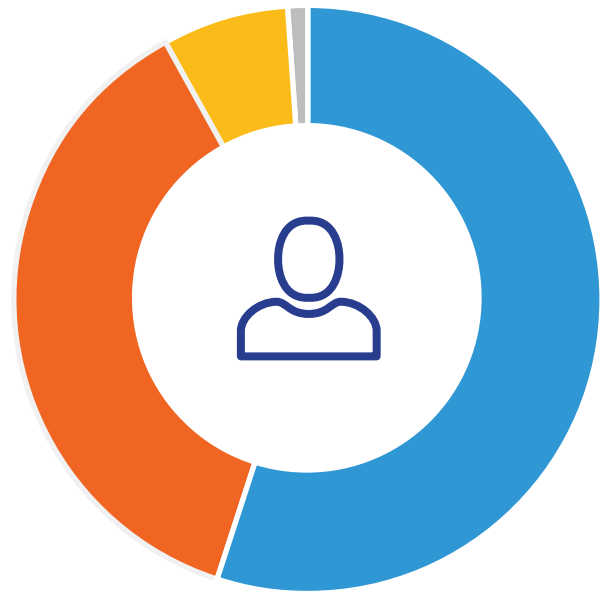

Female Male
Prefer Not to Say Other

Ethnic Identity

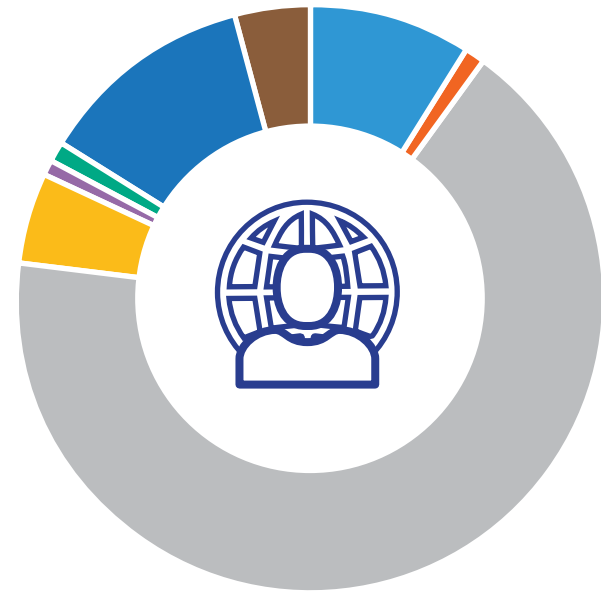

Asian Black/African Caucasian
Hispanic/Latinx Native American Pacific Islander
Prefer Not to Say Other

Age



18 - 24 25 - 34
35 - 44 45 - 54
55 - 64 65+

Annual Household Income

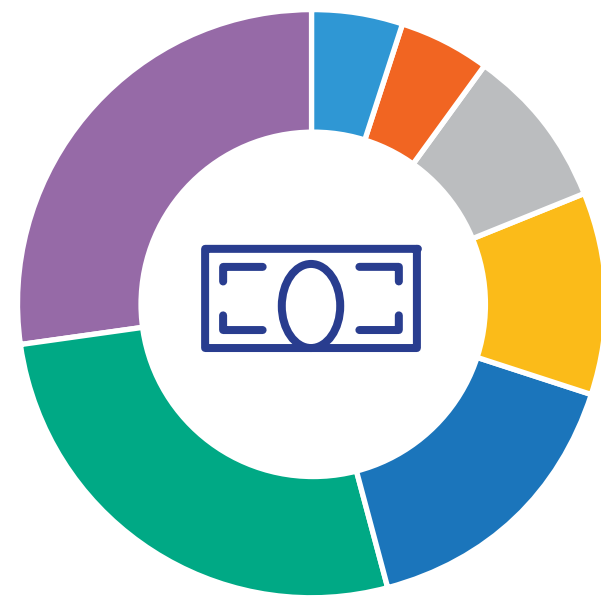

Under \$15K \$15K-29K \$30K-49K
\$50K-\$74K \$75K-\$99K
\$100K-\$150K Over \$150K

Regularity of Station Use

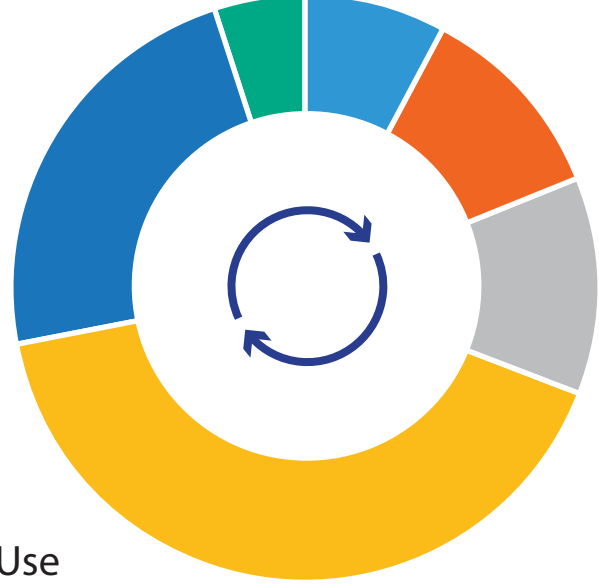

5+ Days of Station Use 2-4 Days Per Week Weekly Monthly
Yearly Never

Respondents primarily came from Davis

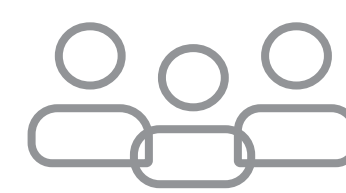
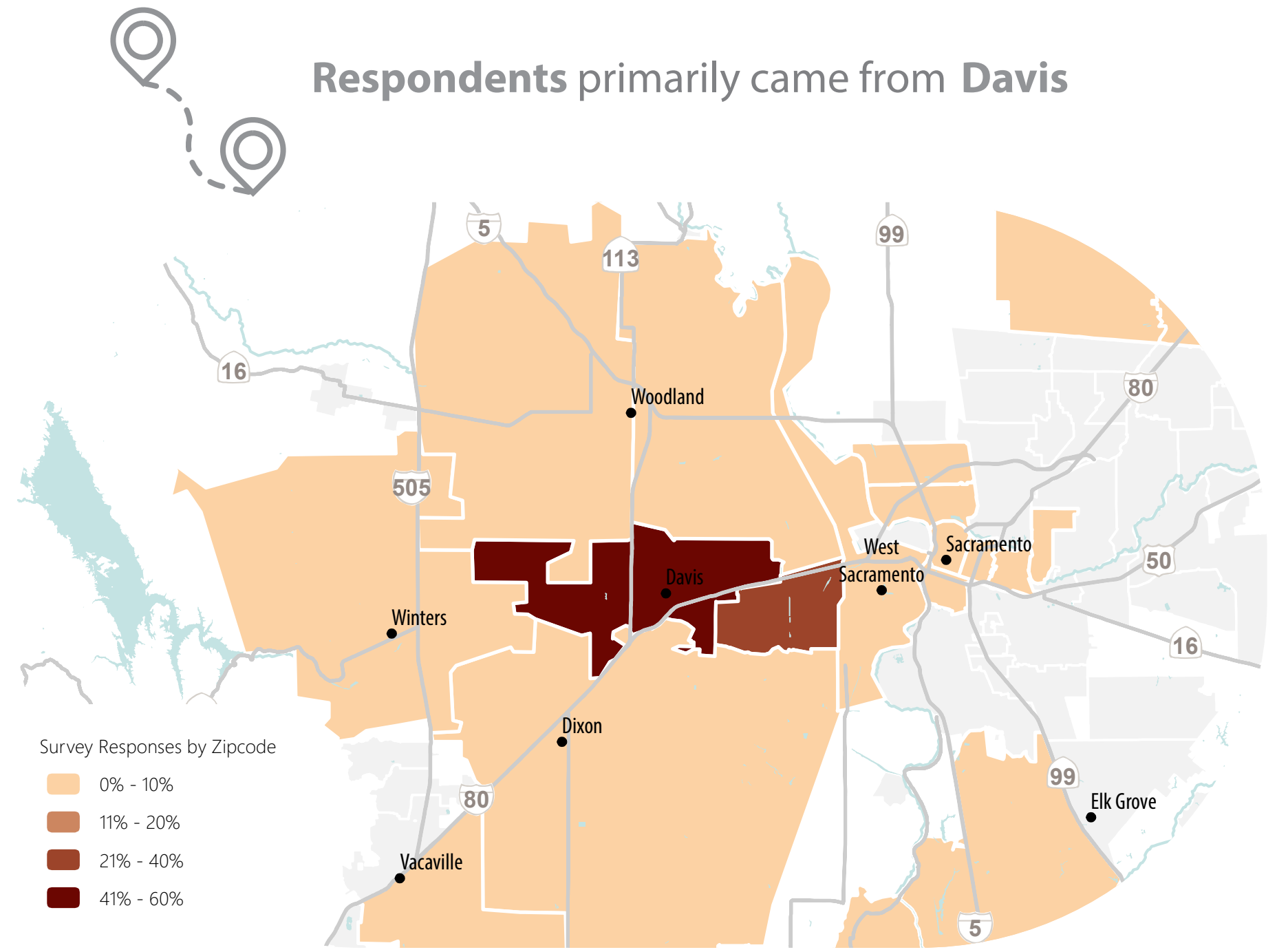

34% of regular users are typically at the station with a **friend, colleague, or family member**



70% of regular users spend **5-30 Minutes** at a time at the station



15% of regular users visit the station to enjoy its **public spaces**

Regular Station Users ranked their level of support for the following improvements:



Irregular and Non Station Users said the following improvements would encourage them to use the station:



