

Construction and Demolition (C&D) Debris Diversion Requirements

The CALGreen building code waste diversion requirements mandate that 100% of all land-clearing debris (dirt, rock and plant materials) and at least 65% of all other C&D debris generated during applicable construction or demolition projects shall be diverted from the landfill through recycle, reuse or composting.

Applicable Projects

- **Agricultural** - Increase of conditioned area (including roofline changes to a barn). Under CALGreen standards, there are NO exemptions for ag related projects.
- **Non-Residential** - Increase of conditioned area (including roofline changes to a business).
- **Additions & alterations** - Whenever a permit is required
- **Residential** - Increase of conditioned area (including roofline changes to a home).
- **Subdivision** - Increase of conditioned area, volume or size.

Projects Not Required to Divert C&D Debris

- Stucco & siding projects
- Window replacements
- Grading projects
- Roofing projects
- Greenhouses
- Non-conditioned areas: patios, pergolas, carports (attached & detached), pre-fab buildings/barns
- Hazardous waste projects

Proper separation of recyclable & non-recyclable C&D debris will help you meet State and local waste diversion mandates. See the back of this flier for details.

Yolo County Jurisdictional Contacts

If you have a construction or demolition project in Yolo County, please contact the recycling program in the jurisdiction you are working in to submit the required waste diversion plans and reports.



Unincorporated Yolo County
530-666-8856
IWM@YoloCounty.org
YoloCounty.org/Landfill



City of Davis
530-757-5686
PWWeb@CityofDavis.org
DavisRecycling.org



City of Woodland
530-661-2063
CandDRecycling@CityofWoodland.org
CityofWoodland.org/CND



City of Winters
530-794-6760
Info@CityofWinters.org
CityOfWinters.org



City of West Sacramento
916-617-4590
Recycle@CityofWestSacramento.org
WestSacRecycles.org

Reuse & repurpose: Buy old stuff and make it new again!

The Big Blue Recycling Barn Thrift Store, located at the Yolo County Landfill sells lumber, doors, windows and other construction materials at low costs. The Barn also accepts reusable building materials for free.

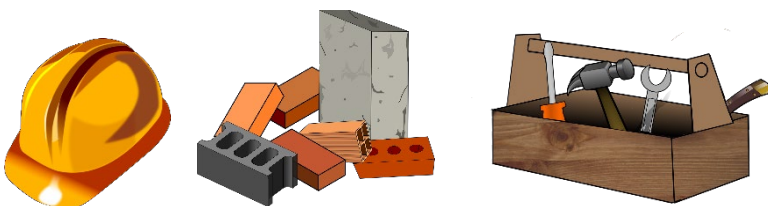

Yolo County Central Landfill

Construction and Demolition Debris Recycling

At the Yolo County Central Landfill, in order for C&D debris to be accepted for recycling, each load must contain at least 65% by weight of the following materials:

WOOD

- Lumber, plywood, pallets
- Branches, logs, yard materials
- Solid wood cabinets
- Plywood, OSB, particle board

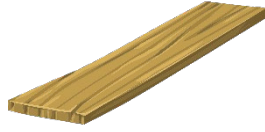

Not accepted for recycling - Fees apply

- Press-board, particle board
- Trash (no food waste)
- Pressure treated wood
- Wood/comp roof shingles
- Wood with lead-based paint

CARDBOARD

- Remove Styrofoam, film plastic and other contents before recycling

DRYWALL

- Gypsum Wallboard/Sheetrock

INERTS

- Concrete, asphalt, bricks
- Dirt, soil, gravel
- Porcelain sinks, toilets, counter tops
- Ceramic floor tile & used roof tiles

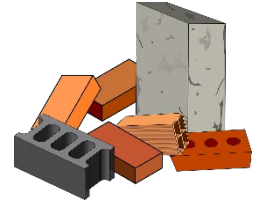

Not accepted for recycling - Fees apply

- Insulation
- Comp/shingle roofing materials

METALS

- Scrap metals (including metal roofing)
- Steel, aluminum, copper
- Appliances - **separate fees apply**

PLASTICS

- Plastics coded #2

Not accepted for recycling - Fees apply

- PVC pipe #3
- Styrofoam or other plastics
- Film plastic, shrink wrap

Hazardous Waste

Hazardous waste cannot be placed in trash, recycling or C&D debris bins. Call 800-207-0204 ext.0204 to schedule an appointment for your business to properly dispose of hazardous waste. Fees apply.

Hazardous items that cannot go into the trash include paint, caulking, non-empty aerosol cans (spray paint), ballasts, spray texture, cylinders containing foam or adhesives, florescent bulbs/tubes, batteries and solvents. For more information, visit YoloCounty.org/Landfill.

WARNING: Cylinders can cost thousands of dollars to dispose of if placed in trash dumpsters. If a cylinder has a puncture tab, follow the manufacturer guidelines to vent, then recycle it with your C&D debris. If the cylinder does not have a puncture tab, it must be managed as hazardous waste.



High Quality vs. Low Quality C&D Debris Loads

Placing recyclable material into separate containers from non-recyclable material at job sites will save money on disposal costs. Instruct workers, vendors and subcontractors on proper waste separation for the maximum diversion.

C&D loads containing:

1. **Minimum of 70% recyclable materials**
= Standard per ton gate rate
2. **Between 50% and 70% recyclable materials**
= Approximately \$10 more per ton than standard rate
3. **Less than 50% recyclable materials***
= Approximately \$60 more per ton than standard rate

Carpet Recycling

Carpet that is separated from the carpet pad, dry, free from debris, cut and rolled into manageable sections can be recycled at the Yolo Landfill (fees apply). Both the carpet and pad can be recycled if rolled separately.



Yolo County Central Landfill

44090 County Road 28H,
Woodland, CA 95776
530-666-8729

IWM@YoloCounty.org
www.YoloCounty.org/Landfill

