

FILENAME: \\16-217\CIVIL\DWG\16-217 CI-OVERALL UTILITY PLANDWG_PLOTTED\Monday, February 05, 2018 11:51 AM

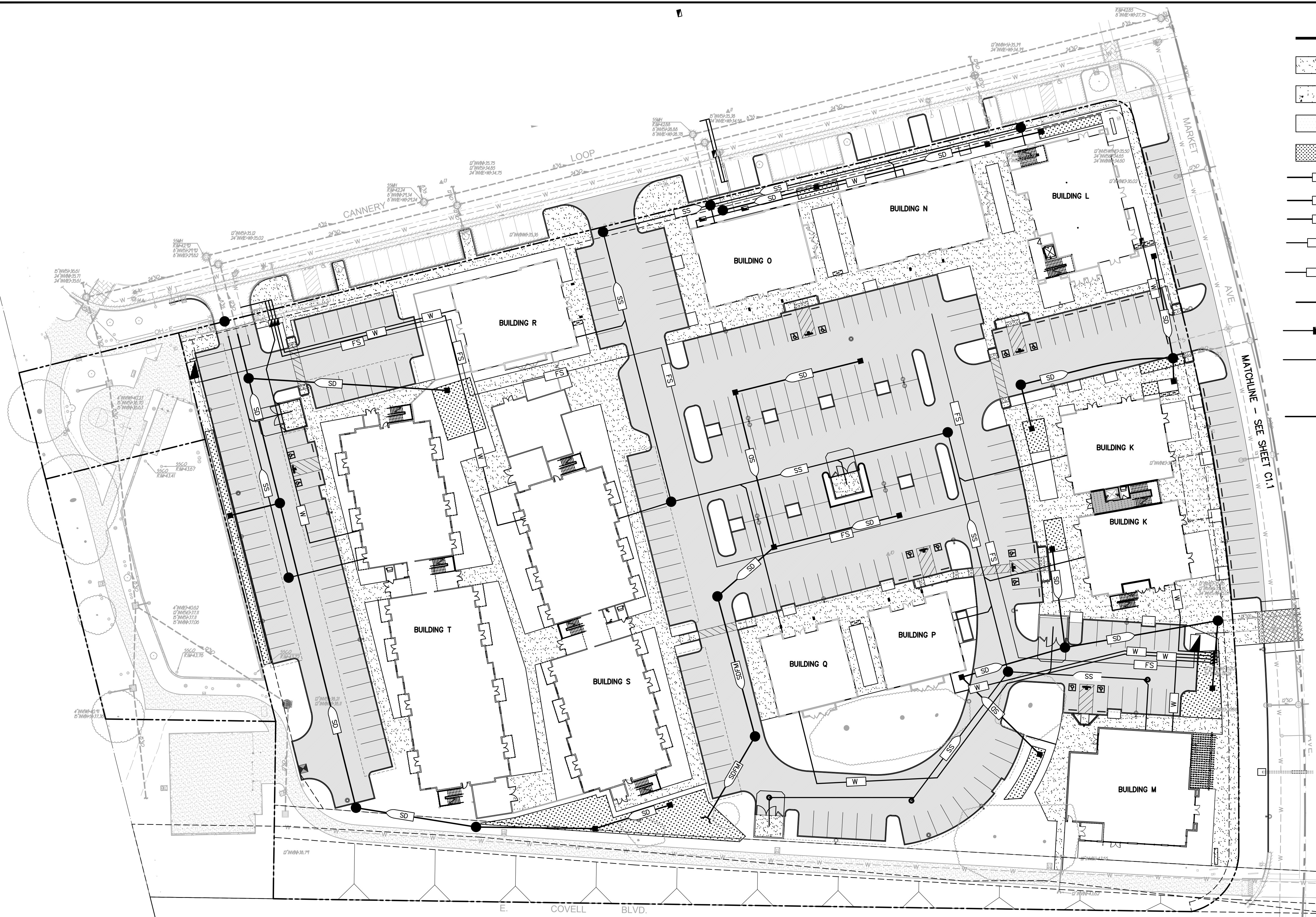

LEGEND

- MIXED USE SITE BOUNDARY
- CONCRETE PAVEMENT
- VALLEY GUTTER
- ASPHALT CONCRETE PAVEMENT
- BIORETENTION AREA
- PROPOSED SANITARY SEWER PIPE
- PROPOSED STORM DRAIN PIPE
- PROPOSED STORM DRAIN FORCE MAIN
- PROPOSED WATER PIPE
- PROPOSED FIRE SERVICE
- SANITARY SEWER CLEAN OUT
- BACKFLOW PREVENTOR
- BUILDING WATER SERVICE
- PROPOSED MANHOLE
- DROP INLET

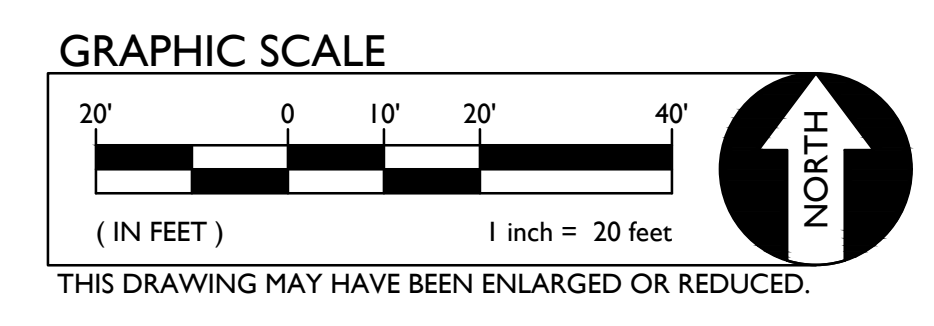

TITLE: PRELIMINARY UTILITY PLAN PROJECT: THE CANNERY 1550 CANNERY AVE. DAVIS CA. 95616 COUNTY OF YOLO CALIFORNIA		A.P.N. _____ BENCHMARK NO. _____ ELEV. _____	
		HORIZONTAL SCALE: AS NOTED VERTICAL SCALE: AS NOTED JOB NO.: 16-217C	AGENCY APPROVAL: _____ DATE: _____ BY: _____
DESIGNED: JMS DRAWN: TB CHECKED: MG DATE: 02-17-17	REVISIONS: NO. DESCRIPTION DATE	REGISTERED PROFESSIONAL ENGINEER - CIVIL THOMAS E. FASSBENDER NO. 44254 STATE OF CALIFORNIA 2/5/2018	
W.C. WARREN CONSULTING ENGINEERS, INC. 1117 WINDFIELD WAY, SUITE 110 EL DORADO HILLS, CA 95762 (916) 965-1870		SHEET NO. C1.1	